



June 23, 2017

Sam Thomas
Thomas Properties
3100 Oak Road Suite #140
Walnut Creek, CA 94597
samthomas@tiogaconstruction.com

Re: Updated Oak Tree Preservation Plan for Rocklin Station, Rocklin

Dear Sam,

Per your request, the following documents are for the Oak Tree Preservation Plan Permit for the proposed Rocklin Station development at 4660 Sierra College Boulevard. The matrix is adapted from the arborist report dated September 21, 2015. It differs from the original table in that it omits non-protected trees and irrelevant information for the permit. I reassessed the trees' separate health and structure ratings to determine one combined rating (good, fair, poor). The updated oak tree preservation plan plots the protected trees on the most recent grading plan.

Summary Table

Total Oak Trees Surveyed	385
Total Non-Protected Oaks (too small)	160
Total Heritage Oaks	7
Protected Oaks to be Removed	225
Oaks Subject to Mitigation	209
Inches Subject to Mitigation	1997.5"

Since the proposed shopping center encompasses the entire site, tree preservation would be difficult with inadequate protection zones available. Many of the oaks have multiple stems and decay resulting from failure of the original trunks. They are growing in dense groves throughout the site with branching to the ground. They are best preserved as groves because exposed interior trees would appear scrubby or skeletal due to shading from adjacent trees. Exposed trees would also be subjected to greater environmental stresses such as wind, which may increase failures of decayed stems.

Of the trees outside the building and driveway footprints, only one mature 42" oak (#377) at the southwest corner of the property had potential for retention. A limited 25'-30' radius protection zone, extensive trunk decay, and a somewhat sparse canopy made it an unreliable prospect for preservation. Based on the updated plan, I recommend all trees be removed for the proposed project.

Thank you for the opportunity to provide this assessment and please feel free to contact me if there are any questions or concerns.

Sincerely,

Jennifer Tso
Certified Arborist #WE-10270A



GRAPHIC SCALE
1"=30'

DATE:	06-13-17	REV #	BY	DESCRIPTION
SCALE:	1"=30'			
DESIGNED:	oms			
DRAWN:	oms			
CHECKED:	oms			
PROJ. MGR.:	oms			
FILE PATH:	Y:\14-2216-ROCKLIN\DATE DIRECTORY\2216GRAD.DWG			

Summary Table

Total Oak Trees Surveyed	385
Total Non-Protected Oaks (too small)	160
Total Heritage Oaks	7
Protected Oaks to be Removed	225
Oaks Subject to Mitigation	209
Inches Subject to Mitigation	1997.5"

OAK TREE PRESERVATION PLAN
 By: Jennifer Tso
 Certified Arborist #WE-10270A
 Traverso Tree Service
 June 23, 2017
 (drawn on latest grading plan)

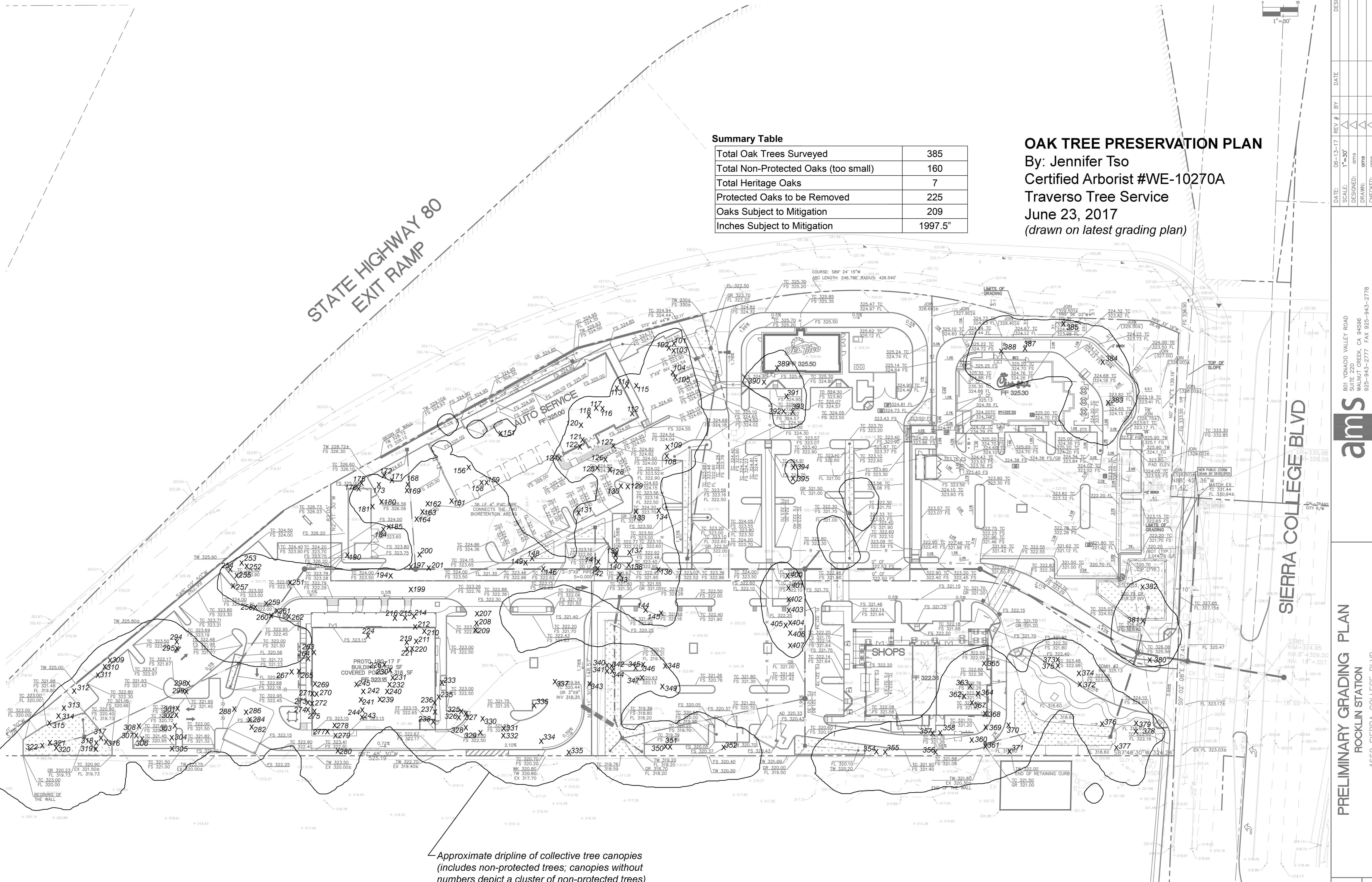

Approximate dripline of collective tree canopies
 (includes non-protected trees; canopies without
 numbers depict a cluster of non-protected trees)
 NOTE: Tree locations were not surveyed and are
 approximately located on this plan.

ams
 801 YGNACIO VALLEY ROAD
 SUITE 220
 WALNUT CREEK, CA 94596
 925-943-2777 FAX 925-943-2778

PRELIMINARY GRADING PLAN
 ROCKLIN STATION
 4660 SIERRA COLLEGE BLVD
 PLACER COUNTY
 CALIFORNIA

SHEET C-3
 OF
 PROJECT
 14-2216
 ROCKLIN

#	Species	TDBH	Heritage	Combined Health & Structure	Remove (for Construction)	Mitigate?	Mitigation Inches
101	Blue Oak (Quercus douglasii)	7.5, 12.5		G	X	X	12.5
102	Live Oak (Quercus sp.)	8, 5.5		F	X	X	8
103	Live Oak	7, 7		F	X	X	7
104	Blue Oak	13.5		P	X		-
105	Live Oak	6.5, 11, 9		F	X	X	11
106	Live Oak	20, 20		F	X	X	20
108	Live Oak	11.5		F	X	X	11.5
109	Live Oak	11		F	X	X	11
110	Live Oak	9, 8.5, 6.5		F	X	X	9
111	Live Oak	11, 12.5, 9, 10		P	X		-
112	Live Oak	8.5, 9.5, 9, 9, 7.5, 8		F	X	X	9.5
113	Blue Oak	16.5		F	X	X	16.5
114	Live Oak	4.5, 5, 9.5, 6		F	X	X	9.5
115	Blue Oak	18		F	X	X	18
116	Live Oak	10		F	X	X	10
117	Blue Oak	12		F	X	X	12
118	Live Oak	6, 8		F	X	X	6
120	Live Oak	4, 5, 4.5, 8.5		F	X	X	8.5
121	Live Oak	8, 4		F	X	X	6
122	Live Oak	5, 8		F	X	X	6
124	Live Oak	4, 7		F	X	X	7
125	Blue Oak	11		F	X	X	11
126	Live Oak	8		F	X	X	6
127	Blue Oak	14		F	X	X	14
128	Live Oak	11.5, 9		P	X		-
129	Live Oak	16		P	X		-
130	Live Oak	7		F	X	X	7
131	Live Oak	17		F	X	X	17
133	Blue Oak	11.5, 8		P	X		-
134	Blue Oak	19.5		P	X		-
136	Live Oak	20.5		F	X	X	20.5
137	Live Oak	14.5, 14		F	X	X	14.5
138	Blue Oak	12.5		F	X	X	12.5
139	Live Oak	11		F	X	X	11
140	Live Oak	14		F	X	X	14
141	Live Oak	5, 8		F	X	X	6
142	Live Oak	10.5		P	X		-

4080 Cabrillo Drive · Martinez, CA 94553 · Telephone (925) 930-7901 · Fax (925) 723-2442

#	Species	TDBH	Heritage	Combined Health & Structure	Remove (for Construction)	Mitigate?	Mitigation Inches
284	Live Oak	4, 8, 10, 3, 3		F	X	X	10
285	Live Oak	8		F	X	X	8
287	Live Oak	4, 6		F	X	X	6
289	Live Oak	6, 6, 4, 5		F	X	X	6
270	Live Oak	7, 6, 4, 3		F	X	X	7
271	Live Oak	3, 6, 3, 5		F	X	X	6
272	Live Oak	7, 4, 3, 3, 4, 3, 5, 7, 4		F	X	X	7
273	Live Oak	10, 4, 4, 4, 2		F	X	X	10
274	Live Oak	8, 3, 3, 3		F	X	X	8
275	Live Oak	6, 5, 3, 2		F	X	X	6
277	Live Oak	6, 2, 3, 6, 3, 3, 4, 4, 3, 3, 5		F	X	X	6
278	Live Oak	3, 7, 2, 5		F	X	X	7
279	Live Oak	12, 14, 5, 5, 5		F	X	X	14
280	Live Oak	6, 5, 3, 3		F	X	X	6
282	Live Oak	8, 8		F	X	X	6
284	Live Oak	7, 24	X	F	X	X	24
286	Live Oak	6, 6, 6, 3, 4, 2, 8		F	X	X	6
288	Live Oak	5, 8, 2, 2		F	X	X	6
294	Live Oak	7		F	X	X	7
295	Live Oak	9, 2		F	X	X	9
298	Live Oak	5, 13		F	X	X	13
299	Live Oak	8, 6		F	X	X	6
301	Live Oak	7		F	X	X	7
302	Valley Oak (Quercus lobata)	8, 8, 4		F	X	X	9
303	Live Oak	8.5, 8		P	X		-
304	Live Oak	6, 4.5		F	X	X	6
305	Live Oak	6.5, 6, 11		F	X	X	11
306	Live Oak	8.5, 4		F	X	X	8.5
307	Live Oak	3.5, 6		F	X	X	6
308	Live Oak	5, 8, 7, 3, 7, 8		F	X	X	8
309	Live Oak	6, 3		F	X	X	6
310	Live Oak	6, 3, 5, 5, 4, 8, 4, 4, 6		F	X	X	8
311	Live Oak	6, 2		F	X	X	6
312	Live Oak	6, 4, 3		F	X	X	6
313	Live Oak	5, 4, 4, 9, 8, 12		P	X		-

#	Species	TDBH	Heritage	Combined Health & Structure	Remove (for Construction)	Mitigate?	Mitigation Inches
143	Live Oak	13, 13		F	X	X	13
144	Live Oak	24.5	X	F	X	X	24.5
145	Live Oak	14, 23.5		F	X	X	23.5
146	Live Oak	8.5		F	X	X	8.5
148	Live Oak	6, 3, 4, 4		F	X	X	6
149	Live Oak	8.5, 5, 4.5, 6		F	X	X	8.5
181	Live Oak	7		F	X	X	7
186	Live Oak	8		F	X	X	6
188	Live Oak	6		F	X	X	6
189	Live Oak	5, 6		F	X	X	6
161	Live Oak	6, 4, 5, 4, 4, 4, 5, 3		F	X	X	6
162	Live Oak	4, 12, 3		F	X	X	12
163	Live Oak	6, 5		F	X	X	6
164	Live Oak	8, 4, 4		F	X	X	8
168	Live Oak	6, 4, 3, 3		F	X	X	6
169	Live Oak	6, 6, 7		F	X	X	7
171	Live Oak	6, 5, 3		F	X	X	6
172	Live Oak	4, 5, 5, 6		F	X	X	6
173	Live Oak	6, 6, 3, 4, 4		F	X	X	6
175	Live Oak	6, 3		G	X	X	6
176	Live Oak	6, 8, 3.5		G	X	X	6
180	Live Oak	6, 3		G	X	X	6
181	Live Oak	6, 5, 3, 3, 4, 5, 5, 4, 2		G	X	X	6
184	Live Oak	4, 3, 6		F	X	X	6
185	Live Oak	7, 3, 3, 4, 4		F	X	X	7
190	Live Oak	5, 4, 4, 3, 6		F	X	X	6
194	Live Oak	5, 3, 6, 4		F	X	X	6
197	Live Oak	8		F	X	X	8
199	Live Oak	6		F	X	X	6
200	Live Oak	6, 5, 4, 5, 4, 4, 5, 4, 4, 2		F	X	X	6
201	Live Oak	6, 6, 4, 4, 3, 3, 2, 3, 5, 4		F	X	X	6
207	Live Oak	6		F	X	X	6
208	Live Oak	7.5		F	X	X	7.5
209	Live Oak	8		F	X	X	8
210	Live Oak	8		F	X	X	8
211	Live Oak	8		F	X	X	8
212	Live Oak	9, 8, 3, 11		F	X	X	9
214	Live Oak	8.5		F	X	X	8.5
215	Live Oak	9, 4, 3, 2		F	X	X	9
216	Live Oak	12, 4, 4		F	X	X	12
219	Live Oak	3, 6, 4, 3, 5		F	X	X	6

Jennifer Tso, Certified Arborist 2

#	Species	TDBH	Heritage	Combined Health & Structure	Remove (for Construction)	Mitigate?	Mitigation Inches
314	Live Oak	8, 4, 4, 3, 4, 3, 4, 3		F	X	X	8
315	Live Oak	6, 4		F	X	X	6
316	Live Oak	7, 4		P	X		-
317	Live Oak	6, 4, 3		P	X		-
318	Live Oak	6, 5.5		F	X	X	6
319	Live Oak	6, 6, 5		F	X	X	6
320	Live Oak	7, 8, 3, 5		F	X	X	8
321	Live Oak	6, 5, 7, 5, 6, 4.5		F	X	X	7
322	Live Oak	18.5, 16.5		P	X		-
325	Live Oak	15, 4		P	X		-
326	Live Oak	6, 6, 6		P	X		-
327	Live Oak	6, 5, 3		F	X	X	6
328	Live Oak	6, 3, 4		F	X	X	6
329	Live Oak	12, 6		F	X	X	12
330	Live Oak	4, 3, 8		F	X	X	8
331	Live Oak	6, 5, 3, 3, 10		F	X	X	10
332	Live Oak	3, 3, 13, 9		F	X	X	13
334	Live Oak	5, 4, 3, 3, 9		F	X	X	9
335	Live Oak	6		F	X	X	6
336	Live Oak	6, 6		F	X	X	6
337	Live Oak	6, 9, 6, 5		F	X	X	9
340	Live Oak	13		F	X	X	13
341	Live Oak	6, 4		F	X	X	6
342	Live Oak	6, 6		F	X	X	6
343	Live Oak	8		F	X	X	8
344	Live Oak	11		F	X	X	11
348	Live Oak	17		F	X	X	17
349	Live Oak	3, 2, 12		F	X	X	12
350	Live Oak	7		F	X	X	7
351	Live Oak	34.5	X	F	X	X	34.5
352	Live Oak	31	X	F	X	X	31
354	Live Oak	12, 7, 5, 12		F	X	X	12
355	Live Oak	20		F	X	X	20
356	Live Oak	12		F	X	X	12
357	Live Oak	12, 4, 4		F	X	X	12
358	Live Oak	12, 4		F	X	X	12
360	Live Oak	6		F	X	X	6
361	Valley Oak	12, 6		F	X	X	12
362	Live Oak	18		F	X	X	18
363	Live Oak	6		F	X	X	6
364	Live Oak	6, 4		F	X	X	6

#	Species	TDBH	Heritage	Combined Health & Structure	Remove (for Construction)	Mitigate?	Mitigation Inches
220	Live Oak	8, 7, 3, 4, 4, 4, 15		F	X	X	15
221	Live Oak	6, 3		F	X	X	6
224	Live Oak	9, 4, 5		F	X	X	9
226	Live Oak	6		F	X	X	6
230	Live Oak	5, 4, 4, 4, 10		F	X	X	10
231	Live Oak	5, 5, 3, 3, 6		F	X	X	6
232	Live Oak	3, 6, 6		F	X	X	6
233	Live Oak	6, 7, 5		F	X	X	7
235	Live Oak	6, 3, 5, 4		F	X	X	6
236	Live Oak	7, 5, 6, 3, 4, 3, 4, 6, 3, 3, 2		F	X	X	7
237	Live Oak	15, 10, 8, 5, 4, 5, 3, 2, 2		G	X	X	15
238	Live Oak	10, 4, 4, 3, 5		F	X	X	10
239	Live Oak	8, 2, 4, 3, 2, 4, 5, 4, 4, 4, 6, 2, 3, 3, 3		G	X	X	8
240	Live Oak	6		F	X	X	6
241	Live Oak	4, 10, 15		F	X	X	15
242	Live Oak	6, 3, 3, 2		F	X	X	6
243	Live Oak	7, 6		F	X	X	7
244	Live Oak	10, 4, 5, 4, 3		F	X	X	10
245	Live Oak	2.5, 6		F	X	X	6
246	Live Oak	6, 5, 5, 4, 3, 3		F	X	X	6
247	Live Oak	6, 4		F	X	X	6
248	Live Oak	6		F	X	X	6
249	Live Oak	6, 6		F	X	X	6
251	Live Oak	6, 7, 5, 5, 4		F	X	X	7
252	Live Oak	3, 6		F	X	X	6
253	Live Oak	6		F	X	X	6
254	Live Oak	6		F	X	X	6
255	Live Oak	8, 5, 4, 4		F	X	X	6
257	Live Oak	6, 5, 8, 3, 3		F	X	X	6
258	Live Oak	7, 8, 9, 5, 3, 2, 3, 3		F	X	X	9
259	Live Oak	5, 6, 4, 3		F	X	X	6
260	Live Oak	6, 7		F	X	X	7
261	Live Oak	6, 4, 5		F	X	X	6
262	Live Oak	6, 5, 7, 4, 3, 2, 2, 6, 3, 3, 2, 6		F	X	X	7
263	Live Oak	6, 2, 2		F	X	X	6

Jennifer Tso, Certified Arborist 3