

220 D-4

ANDREGG, INC.

SURVEYING • MAPPING • GEOMATICS

STATION DESCRIPTION & SKETCH

JN 11559-00 Project Name: City of Rocklin Control Network

QUADRANGLE NAME: Roseville STATION NAME: G1200 (R 8-16)

Approximate Latitude: 38° 47' 9.76" N Approximate Longitude: 121° 14' 26.32" W

Described by: D. Remington Date: 1-8-03

To reach the point from intx of Rocklin Rd & Pacific St. Proceed South 0.4 mile to Farnon St, turn right and proceed westerly 0.1 ± mile to RR tracks, turn left on dirt road, on westerly side, & proceed southwesterly to top of small hill & station on rock outcrop.

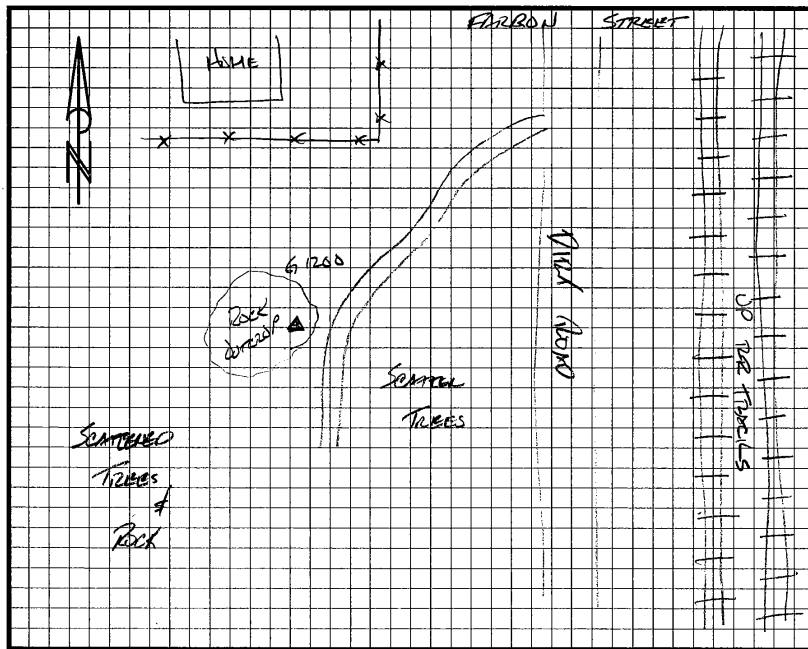

The point is marked by USC & GS Brass Disk and is Flush with the ground.

