

STATION DESCRIPTION & SKETCH

JN 11559-00 - Project Name: CITY OF ROCKLIN CONTROL NETWORK

QUADRANGLE NAME: Rocklin STATION NAME: RM 126 (R.12-5)

Approximate Latitude: 38° 46' 25.86" N Approximate Longitude: 121° 14' 20.77" W

Described by: PETER BALDO Date: 4/2/03

To reach the point (VESTA OAKS SITE) LARGE OPEN SPACE AREA (+OR-) 100' FT. EAST OF SECRET RAVINE 150' (+OR-) SOUTH OF CREEK CROSSING. PT. IS 0.4 MILES SOUTH OF END PAVEMENT OF CHINA GARDEN ROAD. CAN REACH POINT FROM SCAR BROUGH DR. USING A NUMBER OF DIRT ROADS THAT ARE NOT NAMED OR LABELED ON MAPS OF AREA.

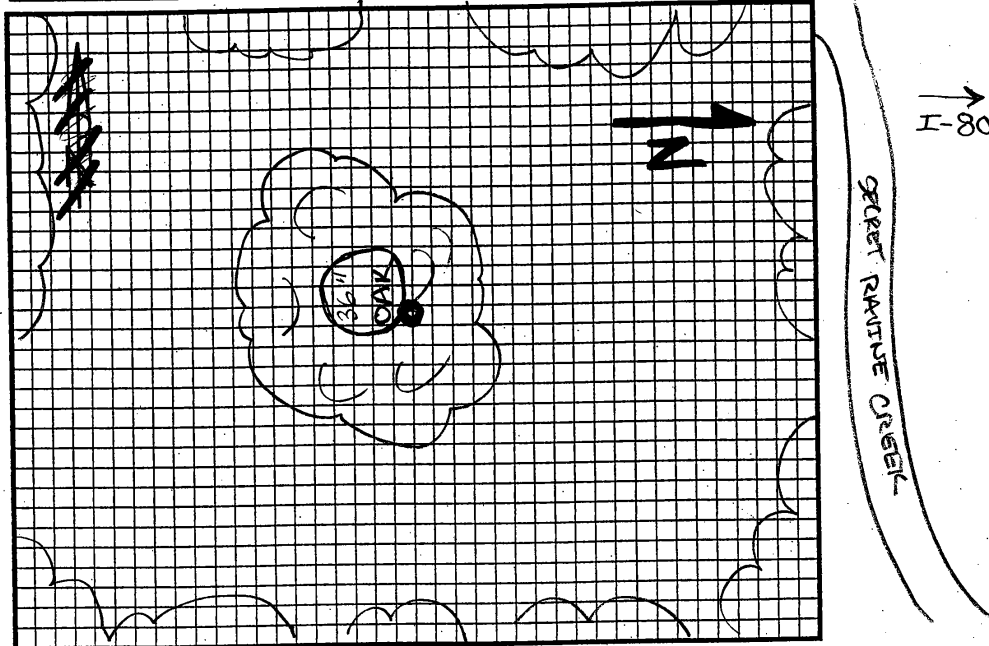

The point is marked by RAILROAD SPIKE and is the ground-
AND 1/2 INCH METAL DISK STAMPED 476 IN NORTH FACE
OF BASE OF 36\" OAK ALL ALONE IN FLAT OPEN
AREA SOUTH OF SECRET RAVINE. PT. IS (+OR-) 500-
600 FEET SOUTH OF INTERSTATE 80.