



June 1, 2016

Sam Thomas
 Thomas Properties
 3100 Oak Road Suite #140
 Walnut Creek, CA 94597
samthomas@tiogaconstruction.com

Re: Oak Tree Preservation Plan Permit for 4660 Sierra College Boulevard, Rocklin

Dear Sam,

Per your request, the following documents are for the Oak Tree Preservation Plan Permit for the proposed development at 4660 Sierra College Boulevard. The matrix below is adapted from the arborist report dated September 21, 2015. It differs from the original table in that it omits non-protected trees and non-required information for the permit. I have also attached an updated tree inventory map that overlays the protected trees on the most recent grading plans.

We considered options for preserving tree #377, a mature oak at the southwest corner of the property, since it is further from construction. Unfortunately, its canopy is sparse and there is significant decay in the lower trunk.

Tree Inventory & Assessment Table

#: Each tree was given a numerical tag sequence from #101-407 (not every number was used).
DBH = Trunk diameters (in inches) were calculated from the circumference measured at 4.5' above grade.

Health & Structural Condition Rating

Dead: Dead or declining beyond chance of recovery.

Poor: Stunted or declining canopy, poor foliar color, possible disease or insect issues. Severe structural defects that may or may not be correctable. Usually not a reliable specimen for preservation.

Fair: Fair to moderate vigor. Minor structural defects that can be correctable. More susceptible to construction impacts than a tree in good condition.

Good: Good vigor, and color, with no obvious problems or defects. Generally more resilient to impacts.

Very Good: Exceptional specimen with excellent vigor, and structure. Unusually nice.

#	Species	DBH	Health	Structure	Remove (for Construction)
101	Live Oak (Quercus sp.)	7.5, 12.5	G	G	X
102	Live Oak (Quercus sp.)	8, 5.5	G	P	X
103	Live Oak (Quercus sp.)	7, 7	F	F	X

#	Species	DBH	Health	Structure	Remove (for Construction)
104	Blue Oak (Quercus douglasii)	13.5	P	F	X
105	Live Oak (Quercus sp.)	6.5, 11, 9	F	F	X
106	Live Oak (Quercus sp.)	20, 20	G	F	X
108	Live Oak (Quercus sp.)	11.5	F	F	X
109	Live Oak (Quercus sp.)	11	F	G	X
110	Live Oak (Quercus sp.)	9, 8.5, 6.5	F	F-P	X
111	Live Oak (Quercus sp.)	11, 12.5, 9, 10	F-P	F-P	X
112	Live Oak (Quercus sp.)	6.5, 9.5, 9, 9, 9, 7.5, 8	F	F	X
113	Blue Oak (Quercus douglasii)	16.5	F-P	G	X
114	Live Oak (Quercus sp.)	4.5, 5, 9.5, 6	F-P	F	X
115	Blue Oak (Quercus douglasii)	16	F-P	G	X
116	Live Oak (Quercus sp.)	10	F	F	X
117	Blue Oak (Quercus douglasii)	12	F	F	X
118	Live Oak (Quercus sp.)	6, 6	F	F	X
120	Live Oak (Quercus sp.)	4, 5, 4.5, 6.5	F	F	X
121	Live Oak (Quercus sp.)	6, 4	F	F	X
122	Live Oak (Quercus sp.)	5, 6	F	F	X
124	Live Oak (Quercus sp.)	4, 7	F	F	X
125	Blue Oak (Quercus douglasii)	11	F	F	X
126	Live Oak (Quercus sp.)	6	F	F	X
127	Blue Oak (Quercus douglasii)	14	P	G	X
128	Live Oak (Quercus sp.)	11.5, 9	F	P	X
129	Live Oak (Quercus sp.)	16	F	P	X
130	Live Oak (Quercus sp.)	7	G	F	X
131	Live Oak (Quercus sp.)	17	G	F	X
133	Blue Oak (Quercus douglasii)	11.5, 8	F-P	F-P	X
134	Blue Oak (Quercus douglasii)	19.5	P	F	X

#	Species	DBH	Health	Structure	Remove (for Construction)
136	Live Oak (Quercus sp.)	20.5	F	F-P	X
137	Live Oak (Quercus sp.)	14.5, 14	F	F	X
138	Blue Oak (Quercus douglasii)	12.5	P	F	X
139	Live Oak (Quercus sp.)	11	F	F	X
140	Live Oak (Quercus sp.)	14	F	F-P	X
141	Live Oak (Quercus sp.)	5, 6	F	F	X
142	Live Oak (Quercus sp.)	10.5	P	P	X
143	Live Oak (Quercus sp.)	13, 13	F-P	F	X
144	Live Oak (Quercus sp.)	24.5	F	F	X
145	Live Oak (Quercus sp.)	14, 23.5	F	F	X
146	Live Oak (Quercus sp.)	8.5	F	F	X
148	Live Oak (Quercus sp.)	6, 3, 4, 4	F	F	X
149	Live Oak (Quercus sp.)	6.5, 5, 4.5, 5	F	F	X
151	Live Oak (Quercus sp.)	7	F	F	X
156	Live Oak (Quercus sp.)	6	F	F	X
158	Live Oak (Quercus sp.)	6	F	F	X
159	Live Oak (Quercus sp.)	5, 6	F	F	X
161	Live Oak (Quercus sp.)	6, 4, 5, 4, 4, 4, 5, 3	F	F	X
162	Live Oak (Quercus sp.)	4, 12, 3	F	F	X
163	Live Oak (Quercus sp.)	6, 5	F	F	X
164	Live Oak (Quercus sp.)	8, 4, 4	F	F	X
168	Live Oak (Quercus sp.)	6, 4, 3, 3	F	F	X
169	Live Oak (Quercus sp.)	6, 6, 7	F	F	X
171	Live Oak (Quercus sp.)	6, 5, 3	F	F	X
172	Live Oak (Quercus sp.)	4, 5, 5, 6	F	F	X
173	Live Oak (Quercus sp.)	6, 6, 3, 4, 4	F	F	X
175	Live Oak (Quercus sp.)	6, 3	G	F	X

#	Species	DBH	Health	Structure	Remove (for Construction)
176	Live Oak (Quercus sp.)	6, 6, 3.5	G	F	X
180	Live Oak (Quercus sp.)	6, 3	G	G	X
181	Live Oak (Quercus sp.)	6, 5, 3, 3, 4, 5, 5, 4, 2	G	F	X
184	Live Oak (Quercus sp.)	4, 3, 6	F	F	X
185	Live Oak (Quercus sp.)	7, 3, 3, 4, 4	F	F	X
190	Live Oak (Quercus sp.)	5, 4, 4, 3, 6	F	F	X
194	Live Oak (Quercus sp.)	5, 3, 6, 4	F	F	X
197	Live Oak (Quercus sp.)	8	F	F	X
199	Live Oak (Quercus sp.)	6	F	F	X
200	Live Oak (Quercus sp.)	6, 5, 4, 5, 4, 4, 5, 4, 4, 2	F	F	X
201	Live Oak (Quercus sp.)	6, 6, 4, 4, 3, 3, 2, 3, 6, 4	F	F	X
207	Live Oak (Quercus sp.)	6	F	F	X
208	Live Oak (Quercus sp.)	7.5	F	F	X
209	Live Oak (Quercus sp.)	8	F	F	X
210	Live Oak (Quercus sp.)	8	F	F	X
211	Live Oak (Quercus sp.)	8	F	F	X
212	Live Oak (Quercus sp.)	9, 8, 3, 11	F	F	X
214	Live Oak (Quercus sp.)	8.5	F	F	X
215	Live Oak (Quercus sp.)	9, 4, 3, 2	F	F	X
216	Live Oak (Quercus sp.)	12, 4, 4	F	F	X
219	Live Oak (Quercus sp.)	3, 6, 4, 3, 5	F	F	X
220	Live Oak (Quercus sp.)	8, 7, 3, 4, 4, 4, 15	F	F	X
221	Live Oak (Quercus sp.)	6, 3	F	F	X
224	Live Oak (Quercus sp.)	9, 4, 5	F	F	X
226	Live Oak (Quercus sp.)	6	F	F	X
230	Live Oak (Quercus sp.)	5, 4, 4, 4, 10	F	F	X

#	Species	DBH	Health	Structure	Remove (for Construction)
231	Live Oak (Quercus sp.)	5, 5, 3, 3, 6	F	F	X
232	Live Oak (Quercus sp.)	3, 5, 6	F	F	X
233	Live Oak (Quercus sp.)	6, 7, 5	F	F	X
235	Live Oak (Quercus sp.)	6, 3, 5, 4	F	F	X
236	Live Oak (Quercus sp.)	7, 5, 6, 3, 4, 3, 4, 6, 3, 3, 2	F	F	X
237	Live Oak (Quercus sp.)	15, 10, 8, 5, 4, 5, 3, 2, 2	G	F	X
238	Live Oak (Quercus sp.)	10, 4, 4, 3, 5	F	F	X
239	Live Oak (Quercus sp.)	8, 2, 4, 3, 2, 4, 5, 6, 4, 4, 6, 2, 3, 3, 3	G	F	X
240	Live Oak (Quercus sp.)	6	F	F	X
240	Live Oak (Quercus sp.)	4, 10, 15	F	F	X
242	Live Oak (Quercus sp.)	6, 3, 3, 2	F	F	X
243	Live Oak (Quercus sp.)	7, 6	F	F	X
244	Live Oak (Quercus sp.)	10, 4, 5, 4, 3	F	F	X
245	Live Oak (Quercus sp.)	2.5, 6	F	F	X
246	Live Oak (Quercus sp.)	6, 5, 5, 4, 3, 3	F	F	X
247	Live Oak (Quercus sp.)	6, 4	F	F	X
248	Live Oak (Quercus sp.)	6	F	F	X
249	Live Oak (Quercus sp.)	6, 6	F	F	X
251	Live Oak (Quercus sp.)	6, 7, 5, 5, 4	P	F	X
252	Live Oak (Quercus sp.)	3, 6	F	F	X
253	Live Oak (Quercus sp.)	6	F	F	X
254	Live Oak (Quercus sp.)	6	F	F	X
255	Live Oak (Quercus sp.)	6, 5, 4, 4	F	F	X
257	Live Oak (Quercus sp.)	6, 5, 5, 3, 3	F	F	X
258	Live Oak (Quercus sp.)	7, 6, 9, 5, 3, 2, 3, 3	F	F	X

#	Species	DBH	Health	Structure	Remove (for Construction)
259	Live Oak (Quercus sp.)	5, 6, 4, 3	F	F	X
260	Live Oak (Quercus sp.)	6, 7	F	F	X
261	Live Oak (Quercus sp.)	6, 4, 5	F	F	X
262	Live Oak (Quercus sp.)	6, 5, 7, 4, 3, 2, 2, 5, 3, 3, 2, 6	F	F	X
263	Live Oak (Quercus sp.)	6, 2, 2	F	F	X
264	Live Oak (Quercus sp.)	4, 8, 10, 3, 3	F	F	X
265	Live Oak (Quercus sp.)	8	F	F	X
267	Live Oak (Quercus sp.)	4, 6	F	F	X
269	Live Oak (Quercus sp.)	6, 6, 4, 5	F	F	X
270	Live Oak (Quercus sp.)	7, 6, 4, 3	F	F	X
271	Live Oak (Quercus sp.)	3, 6, 3, 5	F	F	X
272	Live Oak (Quercus sp.)	7, 4, 3, 3, 4, 3, 5, 7, 4	F	F	X
273	Live Oak (Quercus sp.)	10, 4, 4, 4, 2	F	F	X
274	Live Oak (Quercus sp.)	8, 3, 3, 3	F	F	X
275	Live Oak (Quercus sp.)	6, 5, 3, 2	F	F	X
277	Live Oak (Quercus sp.)	6, 2, 3, 6, 3, 3, 4, 4, 3, 3, 5	F	F	X
278	Live Oak (Quercus sp.)	3, 7, 2, 5	F	F	X
279	Live Oak (Quercus sp.)	12, 14, 5, 5, 5	F	F	X
280	Live Oak (Quercus sp.)	6, 5, 3, 3	F	F	X
282	Live Oak (Quercus sp.)	6, 6	F	F	X
284	Live Oak (Quercus sp.)	7, 24	F	F	X
286	Live Oak (Quercus sp.)	6, 6, 6, 3, 4, 2, 6	F	F	X
288	Live Oak (Quercus sp.)	5, 6, 2, 2	F	F	X
294	Live Oak (Quercus sp.)	7	F	F	X
295	Live Oak (Quercus sp.)	9, 2	F	F	X
298	Live Oak (Quercus sp.)	5, 13	F	F	X

#	Species	DBH	Health	Structure	Remove (for Construction)
299	Live Oak (Quercus sp.)	6, 6	F	F	X
301	Live Oak (Quercus sp.)	7	F	F	X
302	Valley Oak (Quercus lobata)	9, 8, 4	F	F	X
303	Live Oak (Quercus sp.)	8.5, 8	P	F	X
304	Live Oak (Quercus sp.)	6, 4.5	F	F	X
305	Live Oak (Quercus sp.)	6.5, 6, 11	F	F	X
306	Live Oak (Quercus sp.)	6.5, 4	F	F	X
307	Live Oak (Quercus sp.)	3.5, 6	F	F	X
308	Live Oak (Quercus sp.)	5, 8, 7, 3, 7, 6	F	F	X
309	Live Oak (Quercus sp.)	6, 3	F	F	X
310	Live Oak (Quercus sp.)	6, 3.5, 5, 4, 8, 4, 4, 6	G	F	X
311	Live Oak (Quercus sp.)	6, 2	F	F	X
312	Live Oak (Quercus sp.)	6, 4, 3	F	F	X
313	Live Oak (Quercus sp.)	5, 4, 4, 9, 8, 12	P	F	X
314	Live Oak (Quercus sp.)	8, 4, 4, 3, 4, 3, 4, 3	F	F	X
315	Live Oak (Quercus sp.)	6, 4	F	F	X
316	Live Oak (Quercus sp.)	7, 4	P	F	X
317	Live Oak (Quercus sp.)	6, 4, 3	P	F	X
318	Live Oak (Quercus sp.)	6, 5.5	F	F	X
319	Live Oak (Quercus sp.)	6, 6, 5	F	F	X
320	Live Oak (Quercus sp.)	7, 8, 3, 5	F	F	X
321	Live Oak (Quercus sp.)	6, 5, 7, 5, 6, 4.5	F	F	X
322	Live Oak (Quercus sp.)	18.5, 15.5	P	F-P	X
325	Live Oak (Quercus sp.)	15, 4	P	F	X
326	Live Oak (Quercus sp.)	6, 6, 6	F	P	X
327	Live Oak (Quercus sp.)	6, 5, 3	F	F	X

#	Species	DBH	Health	Structure	Remove (for Construction)
328	Live Oak (Quercus sp.)	6, 3, 4	F	F	X
329	Live Oak (Quercus sp.)	12, 6	F	F	X
330	Live Oak (Quercus sp.)	4, 3, 8	F	F	X
331	Live Oak (Quercus sp.)	6, 5, 3, 3, 10	F	F	X
332	Live Oak (Quercus sp.)	3, 3, 13, 9	F	F	X
334	Live Oak (Quercus sp.)	5, 4, 3, 3, 9	F	F	X
335	Live Oak (Quercus sp.)	6	F	F	X
336	Live Oak (Quercus sp.)	6, 6	F	F	X
337	Live Oak (Quercus sp.)	6, 9, 6, 5	F	F	X
340	Live Oak (Quercus sp.)	13	F	F	X
341	Live Oak (Quercus sp.)	6, 4	F	F	X
342	Live Oak (Quercus sp.)	6, 6	F	F	X
343	Live Oak (Quercus sp.)	8	F	F	X
344	Live Oak (Quercus sp.)	11	F	F	X
348	Live Oak (Quercus sp.)	17	F	F	X
349	Live Oak (Quercus sp.)	3, 2, 12	F	F	X
350	Live Oak (Quercus sp.)	7	G	F	X
351	Live Oak (Quercus sp.)	34.5	F-P	F	X
352	Live Oak (Quercus sp.)	31	F	F	X
354	Live Oak (Quercus sp.)	12, 7, 5, 12	F	F	X
355	Live Oak (Quercus sp.)	20	F	F	X
356	Live Oak (Quercus sp.)	12	G	F	X
357	Live Oak (Quercus sp.)	12, 4, 4	G	F	X
358	Live Oak (Quercus sp.)	12, 4	G	F	X
360	Live Oak (Quercus sp.)	6	F	F	X
361	Valley Oak (Quercus lobata)	12, 6	F	P	X
362	Live Oak (Quercus sp.)	18	G	F	X
363	Live Oak (Quercus sp.)	6	F	P	X

#	Species	DBH	Health	Structure	Remove (for Construction)
364	Live Oak (Quercus sp.)	6, 4	F	F	X
365	Live Oak (Quercus sp.)	8, 7, 10	F	P	X
367	Live Oak (Quercus sp.)	6, 8	F	F	X
368	Live Oak (Quercus sp.)	16	F	G	X
369	Live Oak (Quercus sp.)	19	F	G	X
370	Live Oak (Quercus sp.)	12	F	F	X
371	Live Oak (Quercus sp.)	14, 17	G	F-P	X
372	Live Oak (Quercus sp.)	18, 12, 22	G	F	X
373	Live Oak (Quercus sp.)	6, 16	G	F	X
374	Live Oak (Quercus sp.)	7, 6	F	F	X
375	Live Oak (Quercus sp.)	4, 6	F	F	X
376	Live Oak (Quercus sp.)	8	F	F	X
377	Live Oak (Quercus sp.)	42	F	F-P	X
378	Live Oak (Quercus sp.)	6, 4	G	F	X
379	Live Oak (Quercus sp.)	6, 4, 6, 6, 5, 5	G	G-F	X
380	Live Oak (Quercus sp.)	12, 17, 11, 14	F	F	X
381	Live Oak (Quercus sp.)	31	P	F	X
382	Valley Oak (Quercus lobata)	11, 6	G	F	X
383	Valley Oak (Quercus lobata)	46	F	F	X
384	Live Oak (Quercus sp.)	7, 3	P	F	X
385	Valley Oak (Quercus lobata)	12, 6	G	F	X
387	Live Oak (Quercus sp.)	10	G	G	X
389	Live Oak (Quercus sp.)	8, 8, 6	G	G	X
390	Live Oak (Quercus sp.)	8	F	F	X
391	Live Oak (Quercus sp.)	6, 5, 4, 5, 5	F	F	X
392	Live Oak (Quercus sp.)	4, 6	F	F	X
393	Live Oak (Quercus sp.)	6, 5	F	F	X
394	Live Oak (Quercus sp.)	6, 3	F	F	X

#	Species	DBH	Health	Structure	Remove (for Construction)
395	Live Oak (Quercus sp.)	13	F	F	X
400	Live Oak (Quercus sp.)	10, 13, 11	F	F	X
401	Live Oak (Quercus sp.)	12, 11	F	F	X
402	Live Oak (Quercus sp.)	10	F	G	X
403	Live Oak (Quercus sp.)	7, 11	F	F	X
404	Live Oak (Quercus sp.)	12	F	F	X
405	Live Oak (Quercus sp.)	13	F	F	X
406	Live Oak (Quercus sp.)	7, 6, 6, 7, 4	F	F	X
407	Live Oak (Quercus sp.)	6, 3, 3	G	F	X

Based on the updated plan, I recommend all trees be removed for the proposed project and anticipated future development.

Thank you for the opportunity to provide this assessment and please feel free to contact me if there are any questions or concerns.

Sincerely,



Jennifer Tso
Certified Arborist #WE-10270A

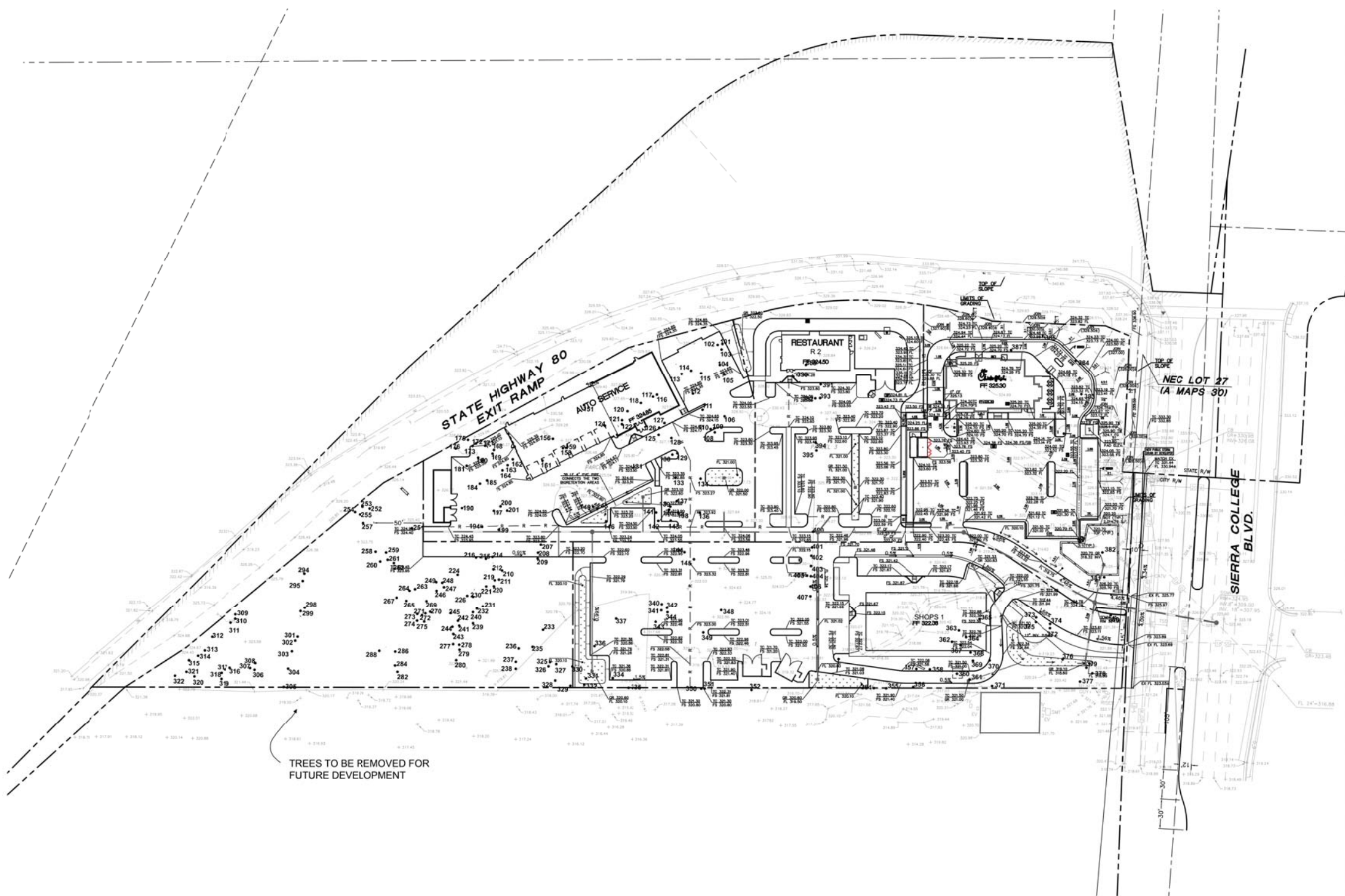

DATE	REV #	BY	DATE	DESCRIPTION
1-16-16	1	JKL		

SCALE: 1"=40'

DESIGNED: [Signature]

DRAWN: SS

CHECKED: AS

PROJ MGR: AS

FILE PATH: \A\14-2216 ROCKLIN\DATE DIRECTOR\210624.DWG

801 YONKOS VALLEY ROAD
SUITE 220
WALNUT CREEK, CA 94596
925-943-2778
925-943-2777

ams
associates, inc. PLANNING ENGINEERING SURVEYING

CALIFORNIA

GRADING PLAN
ROCKLIN STATION
4660 SIERRA COLLEGE BLVD
PLACER

JKLIN

8/13/12 AM 10:53:13

TREE INVENTORY MAP
By: John C Traverso
BCMA Arborist #0206-B
(Inventory completed 9/21/15)