

**STATION DESCRIPTION & SKETCH**

JN 11559-00 - Project Name: CITY OF ROCKLIN CONTROL NETWORK

QUADRANGLE NAME: Rocklin STATION NAME: TBM 438 (52) (R8-5)

Approximate Latitude: 38° 47' 29.40" N Approximate Longitude: 121° 15' 02.32" W

Described by: PETER BALDO Date: 4/3/03

To reach the point FROM INTX SUNSET BLVD AND WHITNEY BLVD  
GO NORTH ON WHITNEY TO INTX FARRON ST. / PARAGON ST.  
AND WHITNEY BLVD. PT ON RT.

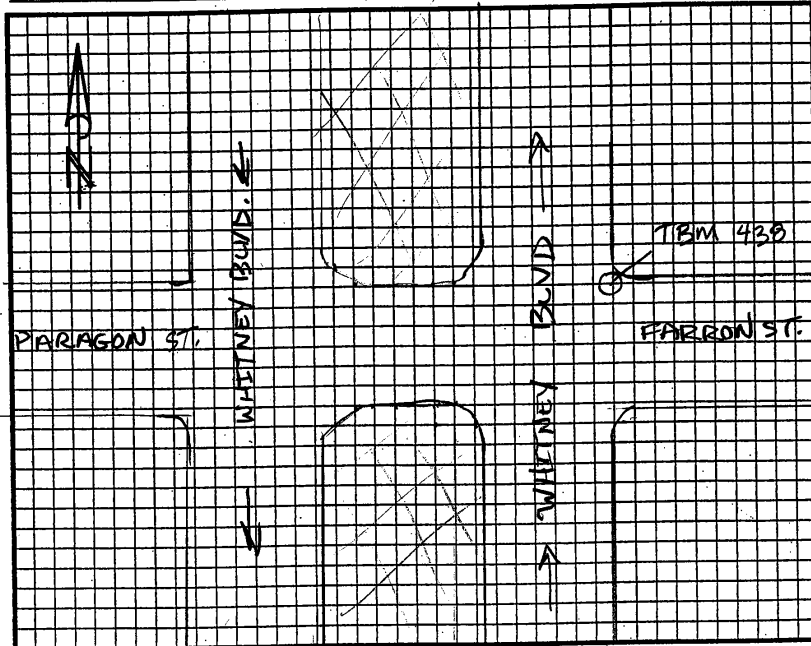

The point is marked by RR SPIKE and is FLUSH W/ the ground.  
PT. IS LOCATED AT EP (+OR-) IN MIDDLE OF CURVE  
OF NORTHEAST QUADRANT OF INTX. FARRON ST AND  
WHITNEY BLVD. 2' EAST OF NORTH END OF STOP  
BAR FARRON ST.