

220 H-1

# ANDREGG, INC.

SURVEYING • MAPPING • GEOMATICS

## STATION DESCRIPTION & SKETCH

JN 11559-00 - Project Name: City of Rocklin Control Network

QUADRANGLE NAME: Rocklin STATION NAME: R (RM B) (R5-2)

Approximate Latitude: 38°48'4.51" N Approximate Longitude: 121°12'15.55" W

Described by: W. WILSON Date: 12-02-02

To reach the point GO EAST FROM INTERSECTION OF SIERRA COLLEGE  
I-80 EAST INTERCHANGE 60' ± TO JOINT POLY  
ON EAST SIDE OF SIERRA COLLEGE

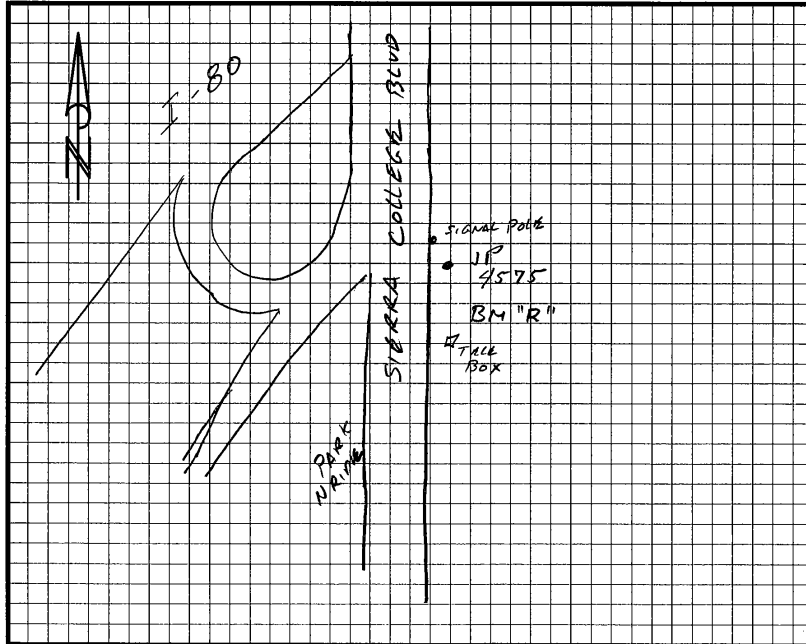

The point is marked by RR SPIKE IN JOINT POLY and is 0.3' ABOVE the ground.  
SPIKE IS IN SOUTHERN FACE OF JP#4575, 5' WEST OF BARB WIRE  
FENCE 15' ± SE OF SIGNAL POLE & 20' ± N OF TABLE BOX

