

220 H-3

ANDREGG, INC.

SURVEYING • MAPPING • GEOMATICS

STATION DESCRIPTION & SKETCH

JN 11559-00 Project Name: City of Rocklin Control Network

QUADRANGLE NAME: Rocklin STATION NAME: RM 79 (R 5-4)

Approximate Latitude: 38°47'19.93" Approximate Longitude: 121°12'20.98"

Described by: W. Wilson Date: 12-02-02

To reach the point FROM INTERSECTION OF ROCKLIN RD & SIERRA COLLEGE BLVD
NE TO TRAFFIC SIGNAL POLE NE OF INTERSECTION & MONUMENT
BRING NW BOLT IN BASE OF SIGNAL POLE

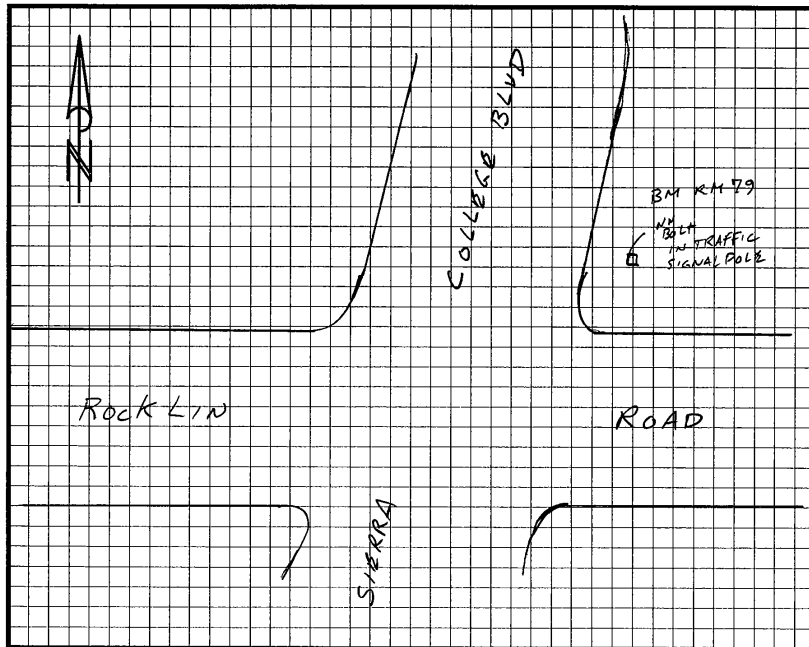

The point is marked by BOLT and is 0.5' ABOVE the ground.

BOLT IS @ NW CORNER OF TRAFFIC SIGNAL POLE BEING EAST
20' ± FROM EAST EDGE OF ASPHALT SIERRA COLLEGE BLVD & 50' ± NORTH
OF NORTH EDGE OF ASPHALT ROCKLIN RD

