

ANDREGG, INC.

SURVEYING • MAPPING • GEOMATICS

STATION DESCRIPTION & SKETCH

JN 11559-00 - Project Name: City of Rocklin Control Network

QUADRANGLE NAME: Rocklin STATION NAME: RSZ (R4-2)

Approximate Latitude: 38° 48' 37.99" N Approximate Longitude: 121° 11' 41.86" W

Described by: W. WILSON Date: 12-02-02

To reach the point FROM THE INTERSECTION OF BRACE RD & DIAS RD
(GO WEST) 200' ± TO I-80 OVERPASS NORTH SIDE
ALONG BRACE RD

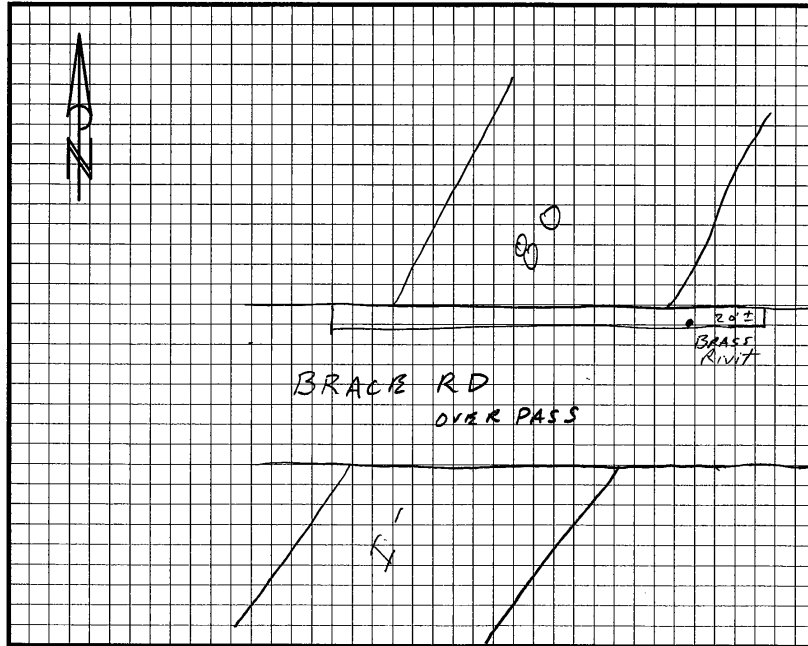

The point is marked by 1/2" BRASS RIVET and is 1' ± ABOVE the ground.
RIVET IS 20' ± WEST OF EAST END OF SIDEWALK ON NORTH SIDE OF
THE OVERPASS 0.5' N OF TFW 4.5' S OF RAIL

